

davit masts

The davit mast separates from the boom and is transportable by means of a permanent pair of wheels at one end. Davit pivoting pins are provided for connection to the davit base. The turning bracket & handle permit easy boom rotation from inside the platform.

All standard masts have a rated capacity of 1150 lbs. or 525kg.

options:

Davit lifting bracket, manual lifting hoist, davit turning handle.

materials:

Type 6061 T-6 aluminum, G40.21-44W galvanized steel
Fy = 44 KSI, A307 zinc plated or A325 galvanized steel, rubber/urethane wheels.



TOP VIEW

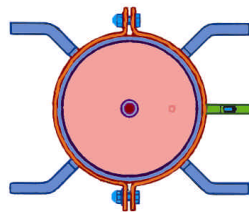

DAVIT MAST

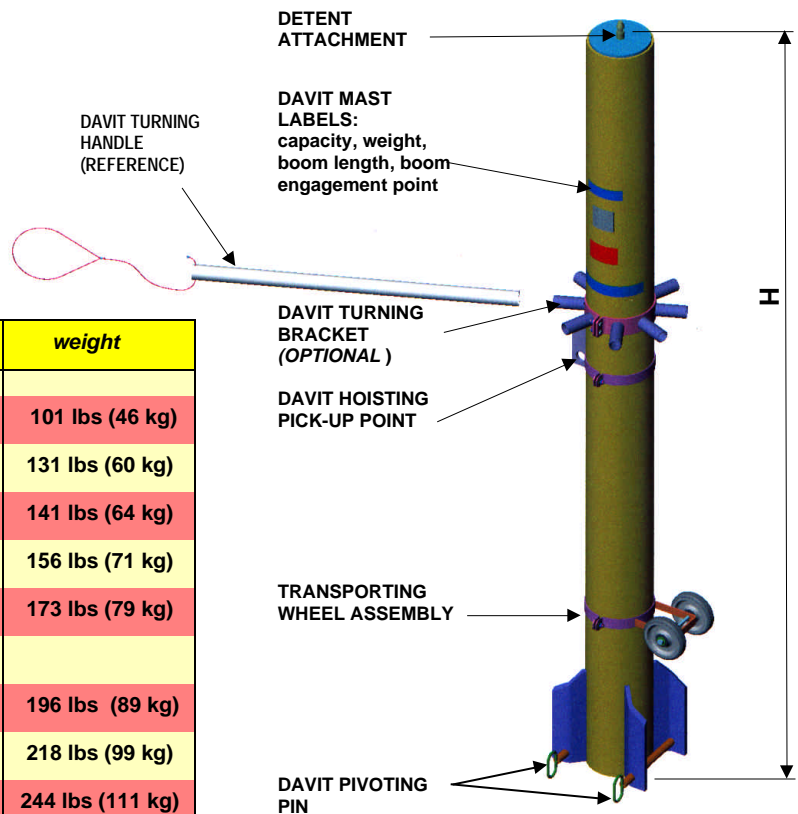

boom reach	model no.	height (H)	weight
5' to 8'-6"	DAM5062-000*	5'-3" (1.63 m)	101 lbs (46 kg)
	DAM5100-000	8'-4" (2.54 m)	131 lbs (60 kg)
	DAM5112-000	9'-4" (2.87 m)	141 lbs (64 kg)
	DAM5130-000	10'-10" (3.33 m)	156 lbs (71 kg)
	DAM5150-000	12'-6" (3.81 m)	173 lbs (79 kg)
9' to 12'-6"	DAM8112-000	9'-4" (2.87 m)	196 lbs (89 kg)
	DAM8130-000	10'-10" (3.33 m)	218 lbs (99 kg)
	DAM8150-000	12'-6" (3.81 m)	244 lbs (111 kg)

* Transporting Wheels Optional

plan